



# Hose-End Degreaser and Sanitizer System

## Package Contents:

1. Injection molded assembly: foaming barrel, handle, and eductor.
2. Concentrate container:  
(1) - 96 oz., (1) - 48 oz.
3. Suction tube/strainer.
4. Spray gun with quick disconnect assembly.
5. Lt. Purple Ultra Lean tip installed in sprayer lid.
6. Product information sheet.

## SAFETY NOTE

- **WEAR** protective clothing and eyewear when dispensing chemicals or other materials.
- **ALWAYS** observe safety and handling instructions of the chemical manufacturers.
- **ALWAYS** direct discharge away from you or other persons or into approved containers.
- **ALWAYS** dispense cleaners and chemicals in accordance with manufacturer's instructions. Exercise CAUTION when maintaining your equipment.
- **CLEAN** equipment after each use in accordance with instruction sheet.
- **WEAR** protective clothing and eyewear when working in the vicinity of all chemicals, filling or emptying equipment or changing metering tips.
- **ALWAYS** re-assemble equipment according to instruction procedures. Be sure all components are firmly screwed or latched into position.
- **ATTACH** only to tap water outlets (85 PSI maximum).

## Operating Instructions:

1. Unscrew foamer lid assembly from container.
2. Select a metering tip using the chart below as a guideline and press the tip firmly into the hose barb on the bottom of the lid assembly. Install the suction tube on the hose barb.
3. Fill the container with concentrate. Screw foamer lid assembly securely onto container.

---

**CAUTION:** Foamer lid assembly must be securely fastened to container to prevent accidental spilling of concentrate during use of foamer.

---

4. Insert foamer lid assembly into female quick connect on spray gun.
5. Connect a garden hose with 3/4" male garden hose thread to the base of the spray gun handle. Turn on the water supply to the hose. (Minimum 25 PSI water pressure is required to operate the foamer.)
6. Grasp the spray gun handle in one hand and the foamer container in the other. Squeeze the spray gun handle to begin foaming. Continuous operation can be achieved by using the handle lock provided on the spray gun. Rinse by disconnecting the spray gun from the foaming lid assembly. To remove the foamer from the spray gun, simply grasp the quick connect on the spray gun in one hand and the foamer assembly in the other. Pull in opposite directions. (The outside collar around the quick connect will slide toward the spray gun, disengaging the foamer barrel.)

## PRODUCT DILUTION CHART

Product	Dilution	Tip Color
Quick Suds #358	1:64	Yellow
	1:32	Green
	1:20	Beige
Food Service Degreaser #2258	1:28	Aqua
	1:96	Yellow
Foaming Restroom & Shower Cleaner #605	1:64	Brown
	1:40	Green
	1:20	Beige
Quat Rinse #2331	1:10	No Tip
	1:512	Lt. Purple

**Troubleshooting Instructions:**

<p><b>Problem</b> 1. Unit does not draw concentrate</p> <p>2. Weak foaming action</p>	<p><b>Cause</b> a. Clogged suction tube strainer b. Metering tip orifice obstructed</p> <p>c. Water pressure too low d. Mineral deposits in barrel of foamer</p> <p>e. Clogged water inlet strainer (low water flow)</p> <p>a. Clogged water inlet strainer b. Water pressure too low c. Water temperature too high</p>	<p><b>Remedy</b> a. Clean or replace b. Rinse tip or replace: Do not attempt to clean: may alter size of orifice c. Minimum 25 PSI required d. Back flush unit. Remove container, tube and metering tip. Put finger over barrel suction opening. Apply minimal water pressure through garden hose at nozzle of barrel to be flushed. d. Descale foamer by soaking in weak descaling solution. e. Clean or replace strainer.</p> <p>a. Clean or replace. b. Minimum 25 PSI required c. Use lower temp water source. (Concentrate flow decreases above 140° F water)</p>
<p>If above steps fail to produce good concentrate draw and/or foaming action, replace lid assembly. See component chart below.</p>		

**PARTS LIST**

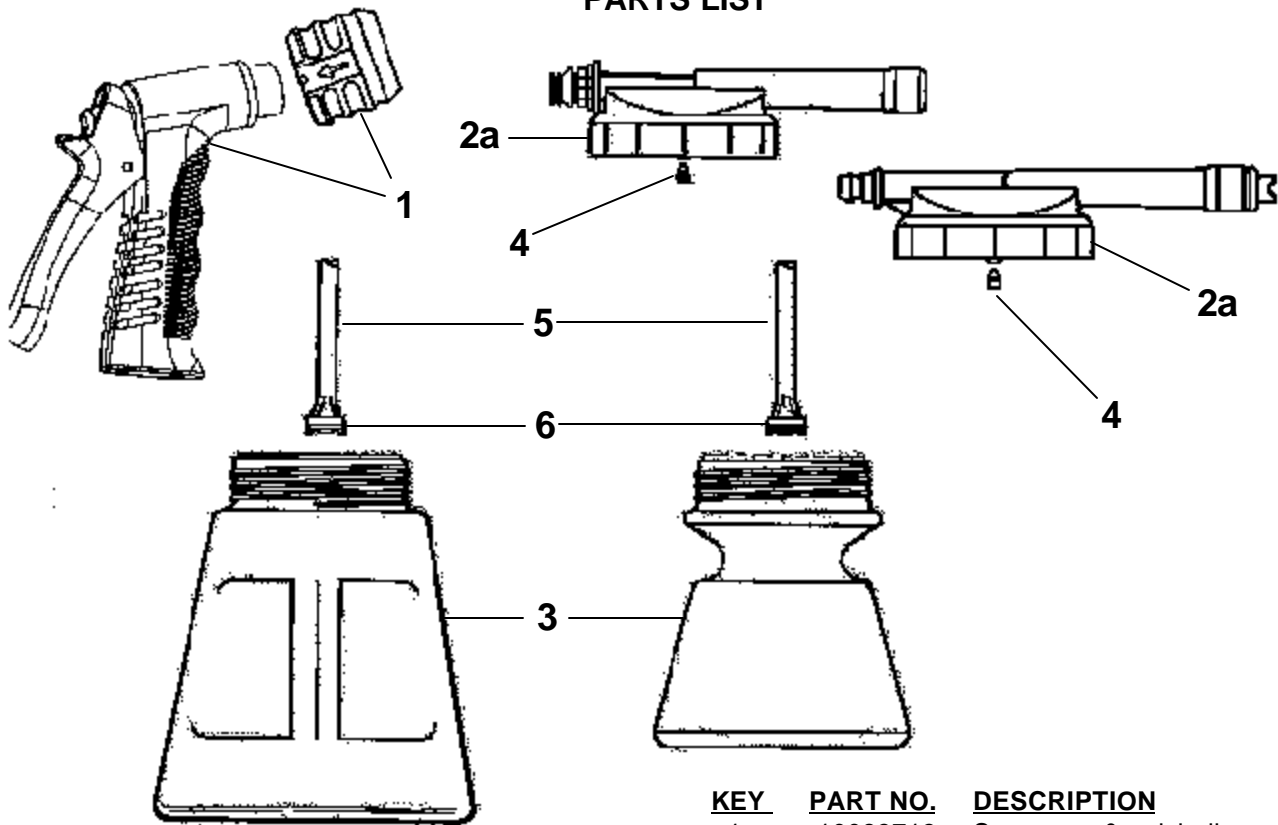

KEY	PART NO.	DESCRIPTION
1	10083713	Spray gun & quick disconnect
2a	10061501	Foamer lid assembly
b	10061502	Sprayer lid assembly
3	688201	Concentrate container - 96 oz.
	688202	Concentrate container - 48 oz.
4	10027001	Lt. Purple ultra lean metering tip
5	500808	Suction tube, 8"
6	609600	Foot strainer



P.O. Box 12 • Merton, WI 53056  
1-800-551-9679 • www.essind.com